

## Installation Guide

### 1. Tools

power drill, hammer, wrench, screwdriver, spirit level

### 2. Components & Quantity



A.middle touch led×1



B.blackboard×2

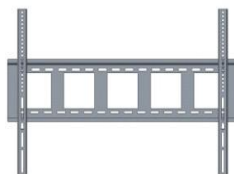

C.bracket×1



D.bracket fastener×8



E.top joint×2



F.bottom joint×2



G.M8 expansion screw×10



H.M4 flat head cap screws×40



I.M4 screw with shoulder×12



J.A4 self-tapping screws×16



K.expansion rubber hose×16

## Installation Guide

### 3. Steps

(1). The position of mount brackets:

Please drill two holes at 10mm diameter to place the brackets as the picture shows. The recommended distance from the floor is 1231m.

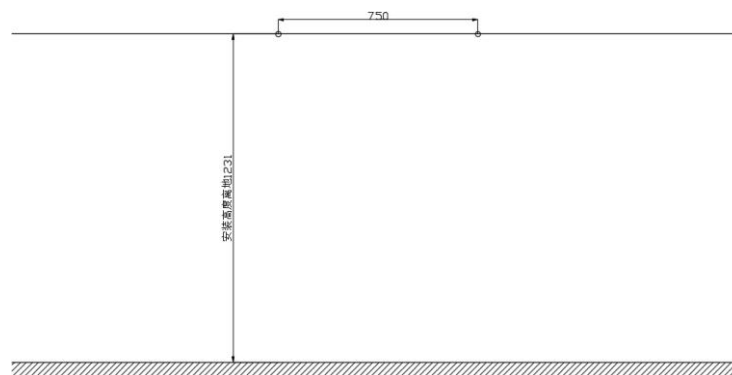

(2). Attache the brackets:

Firstly, insert an expansion screw into the hole, and tap it on the wall with a hammer. Secondly, attach the bracket on the wall and use the spirit level to ensure the brackets in the correct position and level, then drill the other holes and insert expansion screws. Finally, completely tighten the nuts with a screwdriver to fix the brackets.

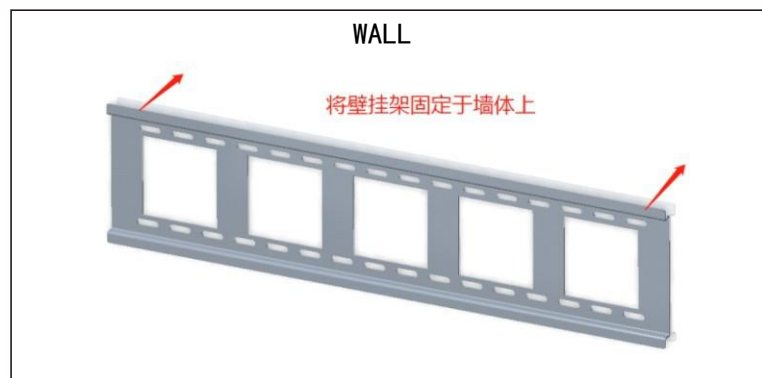

## Installation Guide

### (3). Install the middle touch led:

Please attach the brackets to the bracket pillar. A spirit level may be required to get the brackets in the correct position and level. Besides, make sure the brackets have been firmly fixed on the wall, and then attach the middle touch led to the brackets.

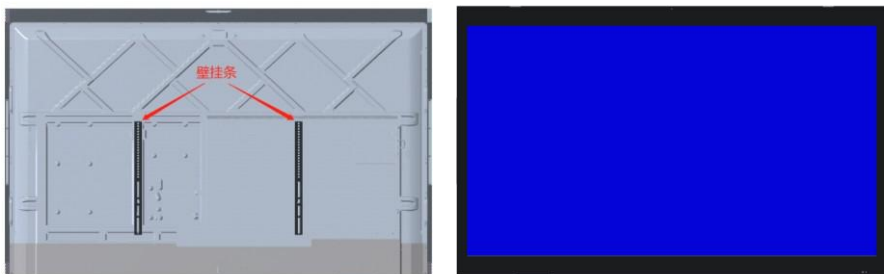

### (4). Install the left blackboard:

You need to fix a top joint onto the upper right corner of the left blackboard, and then connect the blackboard with the middle touch led. Please install the bottom part in the same way. NOTE: The curved side of the joint is required to be against the wall.

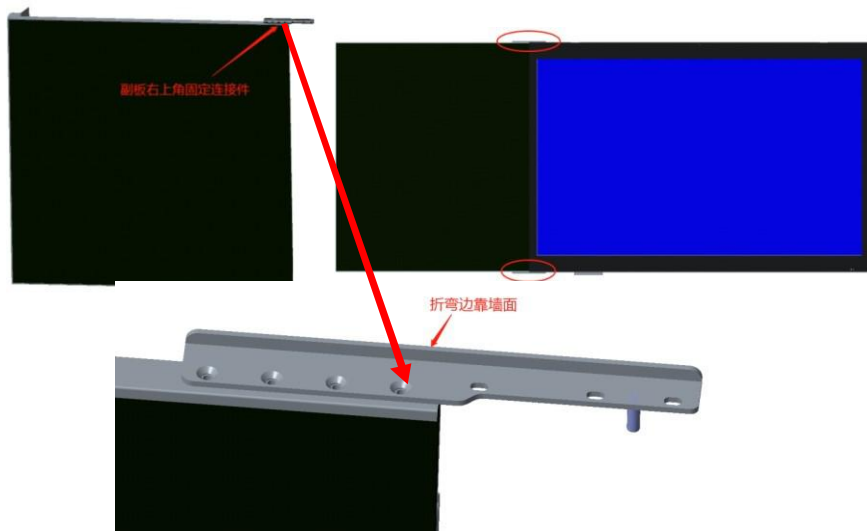

## Installation Guide

### (5). Install the right blackboard:

Referring to the steps of installing the left blackboard, you need to fix a top joint onto the upper left corner of the right blackboard, and then connect the blackboard with the middle touch led. Please install the bottom part in the same way. NOTE: The curved side of the joint is required to be against the wall.

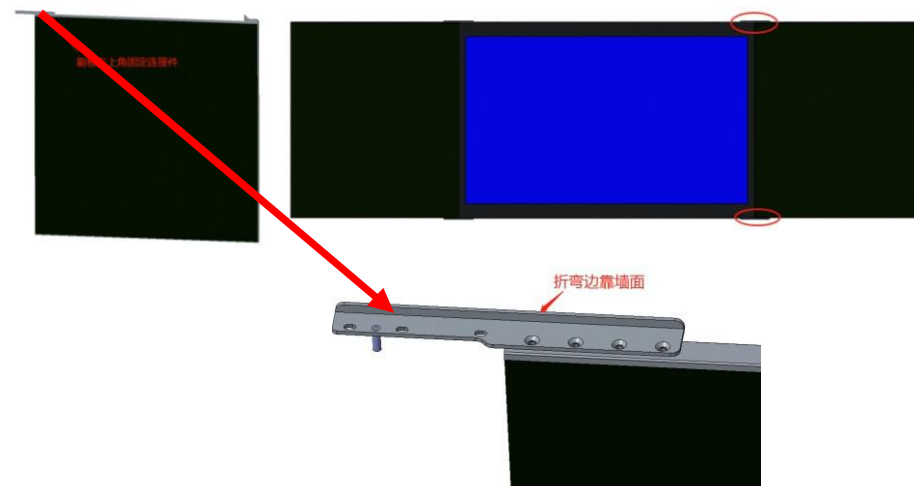

(6). The picture below shows the position of 8 fasteners. Please drill the corresponding holes (diameter: 6mm) for the fasteners, and insert the expansion rubber hose. Finally, use the self tapping screws to fix the device on the wall.

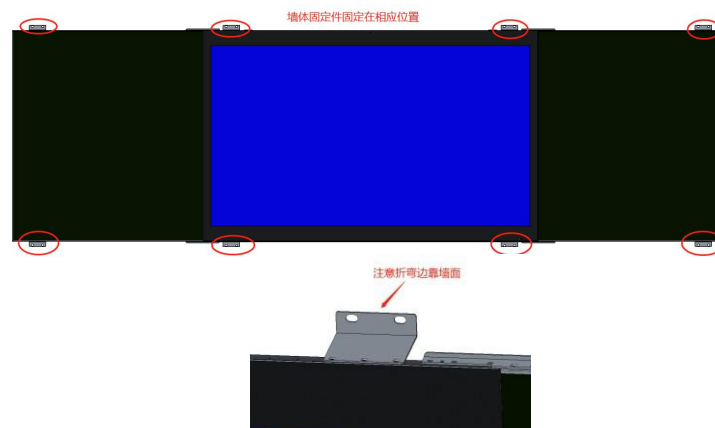

## Installation Guide

(7).Finish. Below is a picture after installation:

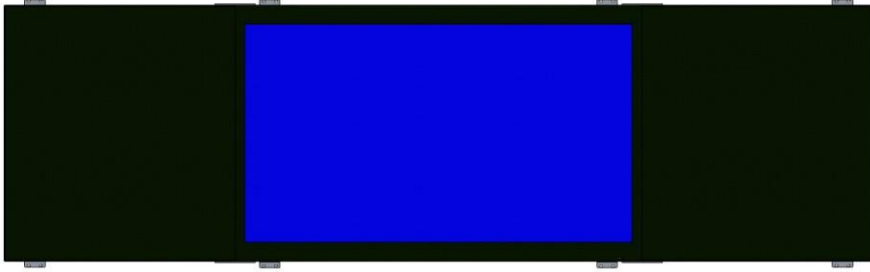

(8).Test:

- Check if the device and software can work normally;
- Check if the network or ports can work normally;
- Check to make sure the touch system can work normally.